

SUBJECT: Laser Sickle Bar Blade Coupler

BCS's commitment to improving the quality of the cutter (sickle) bar attachments requires a replacement connection kit when servicing existing cutter bars going forward.

To summarize the improvements made:

1. A longer, molded socket built with high strength alloy steel increases durability and reduces the risk of breakage.
2. This new socket supports the base of the blade connection, which is partially serrated to allow a better anchorage to the connection itself.
3. The blade coupler was strengthened with additional material, and the fixation of the blade is secured by screws that connect it to the socket.

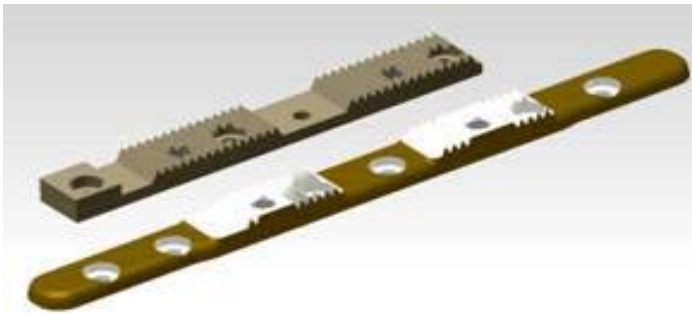

This new connection solution will replace all existing types of blade connections that utilize a serrated coupler to match a serrated blade plate.

The new reinforced blades are mounted on the bar and require the new blade coupler. A replacement kit is available, which includes the new reinforced blade and the new blade coupler. **After replacing the coupler, you will only need to replace the blade.**

To determine whether a blade or a kit is needed, refer to the blade coupler head.

If the blade coupler head looks like this, the kit is required:



If the blade coupler head looks like this, only the replacement blades (no kit) are required:

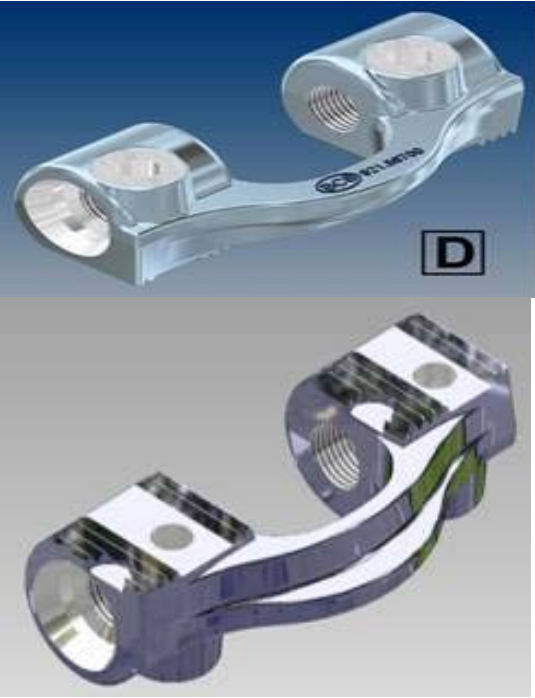



Coupler Part Number 59246663



PLEASE NOTE: If your sickle bar blade coupler is not serrated and looks like these pictured items, please disregard this service bulletin. The items are still available and an upgraded coupler is not needed.

Blade Assembly Part Number

- 30" Blade: 59059030
- 40" Blade: 59059031
- 45" Blade: 59059032
- 53" Blade: 59059033

Please use the following chart to determine the part numbers.

Blade Kit = Blade Set + Coupler Kit

Blade Kit Part #	Description	Blade Set Part #	Description	Coupler Kit Part #	Description
59258875	Kit for 30" Sickle Bar	59058789	Blade Set 30"	59258753	Blade Coupler Kit
59258876	Kit for 40" Sickle Bar	59058790	Blade Set 40"	59258753	Blade Coupler Kit
59258877	Kit for 45" Sickle Bar	59058791	Blade Set 45"	59258753	Blade Coupler Kit
59258878	Kit for 53" Sickle Bar	59058792	Blade Set 53"	59258753	Blade Coupler Kit
59258881	Kit for 45" Self-Adj Sickle	59058796	Blade Set 45" Self-Adj	59258753	Blade Coupler Kit
59258882	Kit for 53" Self-Adj Sickle	59058797	Blade Set 53" Self-Adj	59258753	Blade Coupler Kit
59258886	Kit for 47" Duplex Sickle	59058639	Blade Set 47" Duplex	59258753	Blade Coupler Kit
59258887	Kit for 59" Duplex Sickle	59058646	Blade Set 59" Duplex	59258753	Blade Coupler Kit
59258888	Kit for 71" Duplex Sickle	59058669	Blade Set 71" Duplex	59258753	Blade Coupler Kit

59258753 (Blade Coupler Kit):

- 2 x 31112165
- 1 x 52158700
- 2 x 58058661
- 2 x 58058662

Replacement Blades Key:

Old Part #	Replaced by (Blade Set Only)	Replacement Blade Kit
59048928	59058789	59258875
59059063	59058789	59258875

Old Part #	Replaced by (Blade Set Only)	Replacement Blade Kit
59048926	59058790	59258876
59059064	59058790	59258876

Old Part #	Replaced by (Blade Set Only)	Replacement Blade Kit
59048909	59058791	59258877
59059065	59058791	59258877

Old Part #	Replaced by (Blade Set Only)	Replacement Blade Kit
59048906	59058792	59258878
59059066	59058792	59258878

Old Part #	Replaced by (Blade Set Only)	Replacement Blade Kit
59058684	59058796	59258881

Old Part #	Replaced by (Blade Set Only)	Replacement Blade Kit
59058681	59058797	59258882

47" Duplex

Old Part #	Replaced by (Blade Set Only)	Replacement Blade Kit
59058625	59058639	59258886

59" Duplex Sickle Bar

Old Part #	Replaced by (Blade Set Only)	Replacement Blade Kit
59058585	59058646	59258887

71" Duplex Sickle Bar

Old Part #	Replaced by (Blade Set Only)	Replacement Blade Kit
59058611	59058669	59258888