



Subject: PTO Lock Out Upgrade 10/6/1997

Due to reported inconsistent effectiveness of the PTO reverse lockout from the field, BCS has updated the reversing mechanism for models 710 thru 850. This update can be retro fitted to earlier units. This retro fit should only be performed if the unit has experienced inconsistent PTO disengagement when shifting to reverse gear.

The purpose of this lock out is to prevent the tiller tines from being engaged when the unit is in reverse. The operator should be instructed to disengage the PTO when engaging the reverse gear, but this safety measure should ensure that the PTO is disengaged should the operator fail to remember.

To make this update you will need to order the following parts as specified by unit:

Model 710

Part Number	Description	Quantity
590.57325	PTO Lockout Lever	1
561.57323	PTO Control Lever	1
552.57313	PTO Lockout Ring	1
552.57321	PTO Stop Ring	1

Model 716 - 730

Part Number	Description	Quantity
590.57319	Reverser Lever	1
561.57323	PTO Control Lever	1
552.57313	PTO Lockout Ring	1
552.57321	PTO Stop Ring	1

Model 830 - 850

Part Number	Description	Quantity
590.57315	Reverser Lever	1
561.57324	PTO Control Lever	1
552.57313	PTO Lockout Ring	1
552.57322	PTO Stop Ring	1

The instructions for making this change are as follows:

Model 710

- 1) Remove roll pin (1) from existing PTO lockout lever and discard lever.
- 2) Remove roll pin (2) holding existing PTO control lever from PTO shaft (3). Remove control lever and remove roll pin (4) from existing stop ring. Discard control lever and stop ring.
- 3) Press PTO stop ring (5) on to PTO lockout arm (6) and install lockout arm on unit with roll pin (1).
- 4) Install new stop ring (7) on new PTO control lever (8) locking into position with roll pin (4). Install control lever into position on PTO shaft (3) with roll pin (2).

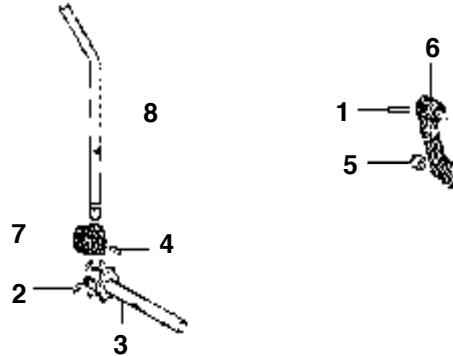

Model 716 - 730

- 1) Remove rear cover.
- 2) Remove gears to expose slider lever for reversing gear. Remove roll pin holding slider lever into position.
- 3) Remove reverse lever return spring (1) and reverse lever. Discard reverse lever.
- 4) Press PTO lockout ring (2) on to new reverse lever (3). Inspect o-ring (4) for reverse lever and replace if necessary. Install reverse lever (3) and reattach return spring (1).
- 5) Install slider lever for reversing gear and lock into position with roll pin.
- 6) Install gears and rear cover sealing with gasket material.
- 7) Remove roll pin (5) holding existing PTO control lever from PTO shaft (6). Remove control lever and remove roll pin (7) from existing stop ring. Discard control lever and stop ring.
- 8) Install new stop ring (8) onto new PTO control lever (9) locking into position with roll pin (7). Install control lever into position on PTO shaft with roll pin (5).

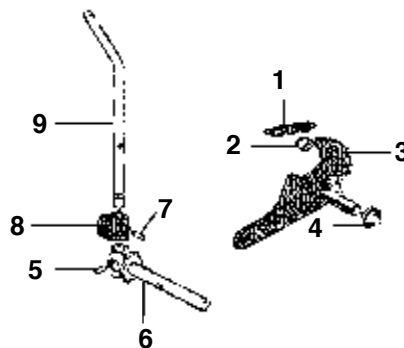

Model 830 - 850

- 1) Release reverser cable (1) by removing cable clamp (2).
- 2) Remove reverser spring (3) and guide pin (4) by removing bolt (5) in guide block (6).
- 3) Remove rear cover.
- 4) Remove gears to expose slider lever for reversing gear. Remove roll pin holding slider lever into position.
- 5) Remove reverse lever and discard.
- 6) Press PTO lockout ring (7) on to new reverse lever (8). Inspect o-ring (9) for reverse lever and replace if necessary. Install reverse lever (8).
- 7) Install slider lever for reversing gear and lock into position with roll pin.
- 8) Install gears and rear cover sealing with gasket material. Install reverser spring (3) and guide pin (4). Install and adjust reverser cable (1).
- 9) Remove roll pin (10) holding existing PTO control lever from PTO shaft (11). Remove control lever and remove roll pin (12) from existing stop ring. Discard control lever and stop ring.
- 10) Install new stop ring (13) onto new PTO control lever (14) locking into position with roll pin (12). Install control lever into position on PTO shaft with roll pin (10).

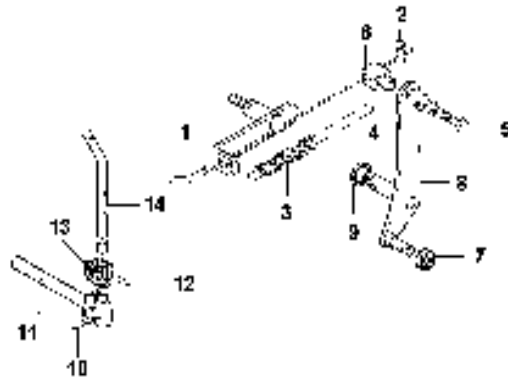

Please contact BCS America, Inc Technical Service at 1-800-543-1040 for detailed instruction on removal of the rear cover.

On units that require this update BCS will pay a labor rate of .75 hours on 710 model tractors and a labor rate of 2.5 hours on 716-850 model tractors. All parts will be covered under warranty.

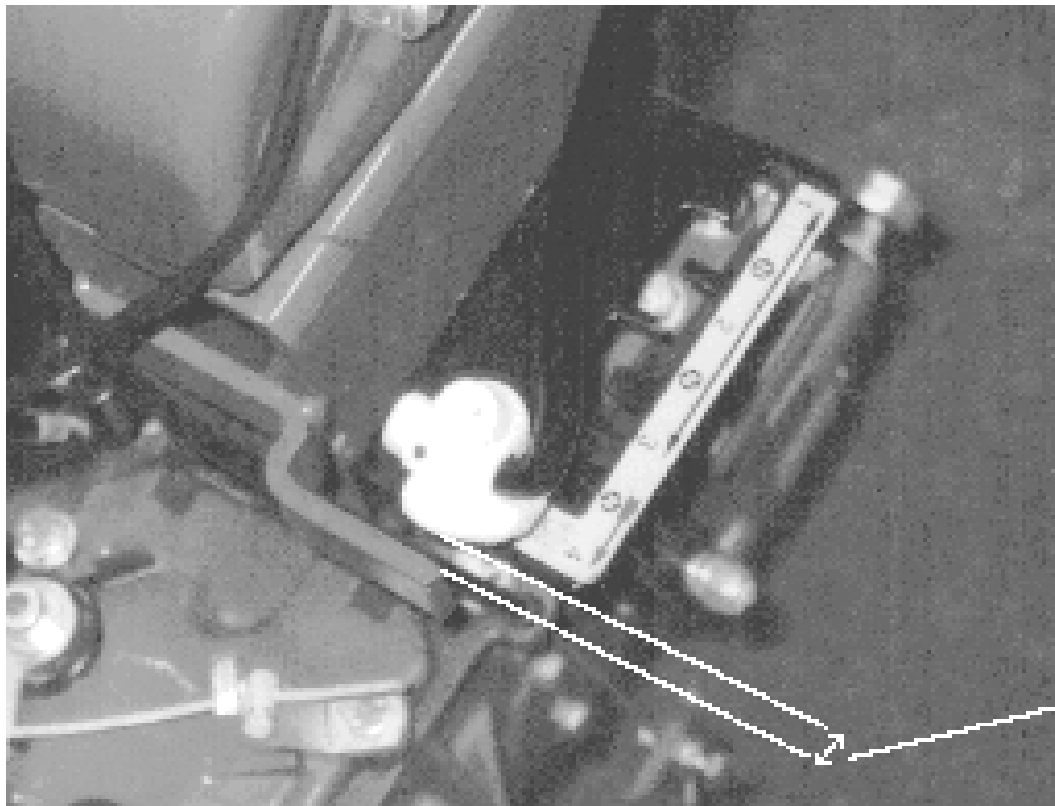

A 2mm to 6mm Gap should exist between the articulator and stop bracket

Illustration 2

We are requesting that all the units be checked for the incorrect decal and gap adjustment. If a tractor has the incorrect decal, the correct decal (p/n 580.57706) should be ordered. This decal will be sent as a no charge order to correct this situation.

To adjust the gap between the articulator and stop bracket, strike the stop bracket with a hammer and bend into position.

If a Decal is replaced a labor time of .25 will be warrantable. If the gap is adjusted a labor time of .25 will be warrantable. If both decal and gap repairs are performed a labor time of .50 will be warrantable.