	<h1>SERVICE INFORMATION</h1>	<h1>2-13</h1>
---	----------------------------------	---------------

Subject: Throttle upgrade for BCS models 710-720 with B & S engines and plastic throttle controls.

We have experienced some difficulty with excessive resistance on the throttle control on models 710, 716, & 720 with Briggs & Stratton engines. Not every one of these models are experiencing this problem, so perform this procedure, under warranty, only if the unit has failed.

To upgrade All model 710, and models 716, & 720 with **VC** engines that have a throttle control bracket with a plastic slider mechanism, follow these steps...

- 1) Begin by removing the nuts (ref.#2) from the bolts (ref.#1) on the original throttle control assembly.
- 2) Once those nuts and bolts have been removed you will be able to lift the entire throttle assembly (ref.#3) from the handlebar.
- 3) Follow the throttle cable down to the control bracket on the engine. Remove the throttle cable clamp (ref.#17) and release the throttle cable from the slider (ref.#18).
- 4) Install the new throttle lever (ref.#4) using bolt and washer (ref.#s 5&6) as illustrated below.
- 5) Install new throttle cable (ref.#7) on to new control lever (ref.#4). Position lever in upright, full throttle position then pull back approximately 1/8".
- 6) Insert speed control clamp (ref.#14) into throttle slider (ref.#18) and secure with screw (ref.#15).
- 7) Clamp throttle cable housing (ref.#13) to the throttle control bracket with cable clamp (ref.#17).
- 8) Position the throttle slider (ref.#18) in the full throttle position.
- 9) Insert the inner throttle wire (ref.#12) through the speed control clamp (ref.#14) pulling the wire as far as it will go, making sure that the wire housing is tight against the throttle control lever (ref.#4).
- 10) Secure the inner throttle wire with screw (ref.#16).
- 11) Install spring anchor (ref.#10) into holes provided on throttle control bracket.
- 12) Install one end of the throttle return spring into the hole on the speed control clamp (ref.#14) and the other end onto the spring anchor (ref.#10), as illustrated below.
- 13) Move the throttle lever back and forth while watching the control bracket to make sure that it is operating properly.

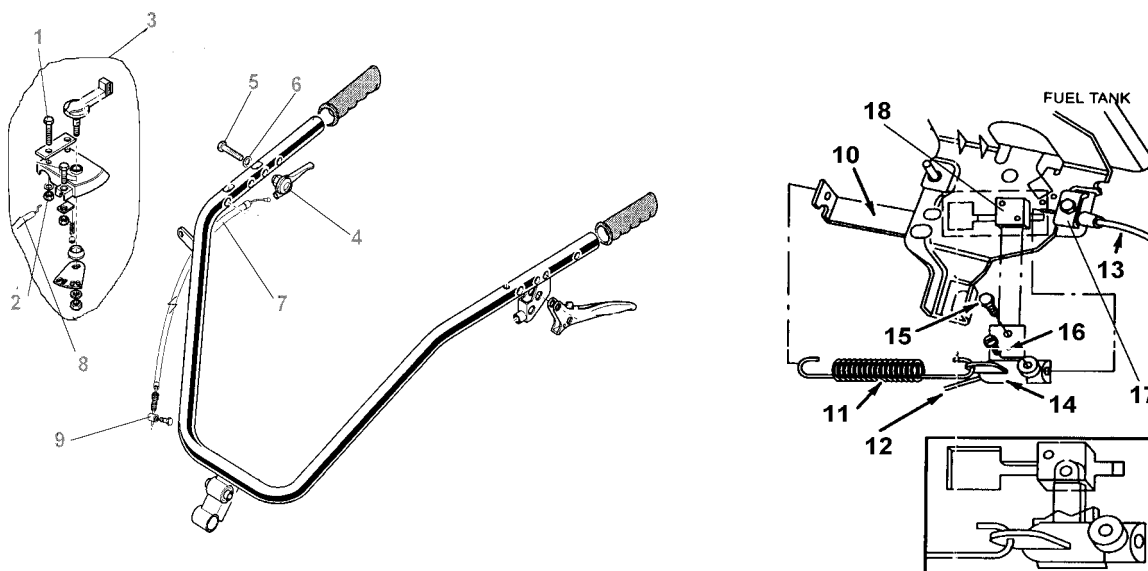

To upgrade model 720 with 8hp **I/P** (Industrial Plus) engines, follow these steps...

- 1) Follow steps 1 through 5 in the first part of this bulletin.
- 2) Set throttle lever (ref.#4) in the downward idle position.
- 3) Loosen wingnut (ref.#1) on throttle control bracket.
- 4) Install spring link (ref.#12) onto throttle tab (ref.#2) located behind governor tab (ref.#3).
- 5) Anchor the cable adjusting screw (ref.#13) onto position on throttle plate (ref.#8) using clamp (ref.#6).
- 6) Thread the inner throttle wire through the adjusting screw (ref.#13) and the spring link (ref.#12).
- 7) Install one end of the return spring (ref.#10) into the hole on the control bracket (ref.#5) and the other end on to the notch of the lever (ref.#4).
- 8) Slide the wire stop (ref.#9) on to the end of the inner throttle wire until it is secure against the hole in the spring link (ref.#12)
- 9) Pull the end of the wire tight keeping the wire stop (ref.#9) against the spring link (ref.#12) making sure that the cable housing is snug against the throttle lever (ref.#4).
- 10) Tighten the securing screw on the wire stop (ref.#9).
- 11) Move the throttle lever back and forth while watching the control bracket to make sure that it is operating properly.

Note: You will be able to turn the adjusting screw (ref.#13) to loosen or tighten the cable as needed.

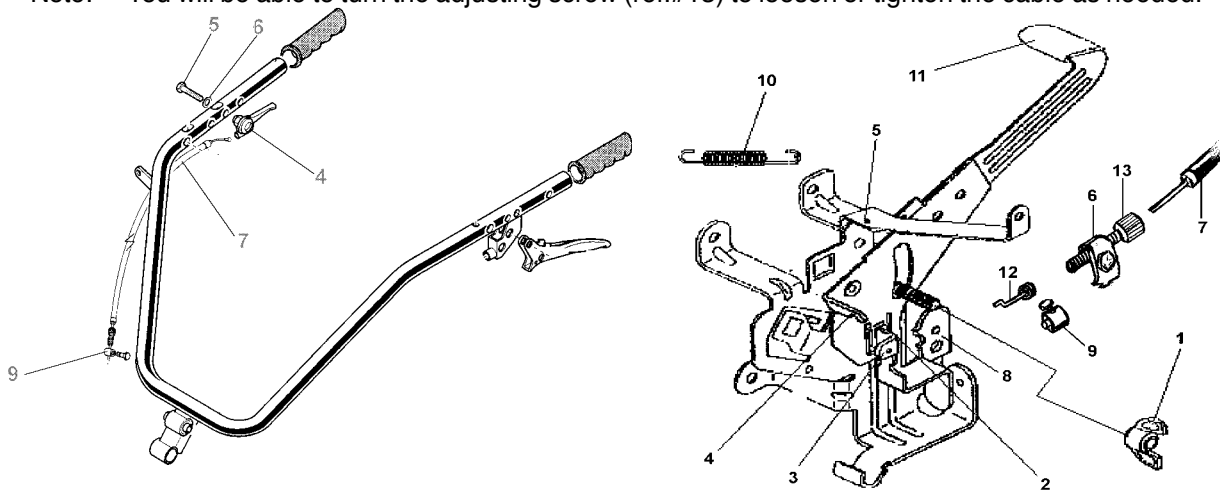

The parts needed for the conversions are as follows:

All 710, and model 716 and 720 with Briggs & Stratton **I/C** engines...

Part No.	Description
59256159K	Throttle Upgrade Kit

Model 716 with Briggs & Stratton 5hp **I/P** engines.

Part No.	Description
59256160K	Throttle Upgrade Kit

Model 720 with 8hp **I/P** (Industrial Plus) Briggs engines.

Part No.	Description
59256161K	Throttle Upgrade Kit